



# Android Whiteboard Manual

The final interpretation of all information in this document belongs to the company, and all unauthorized and permitted reproductions are not recognized and should be banned.

This document may not fully reflect all recent changes to the product, whichever is the actual product.

---

## Software Description

### Writing Whiteboard

#### Interface Display

Click  the whiteboard icon in the main interface to start the whiteboard software.

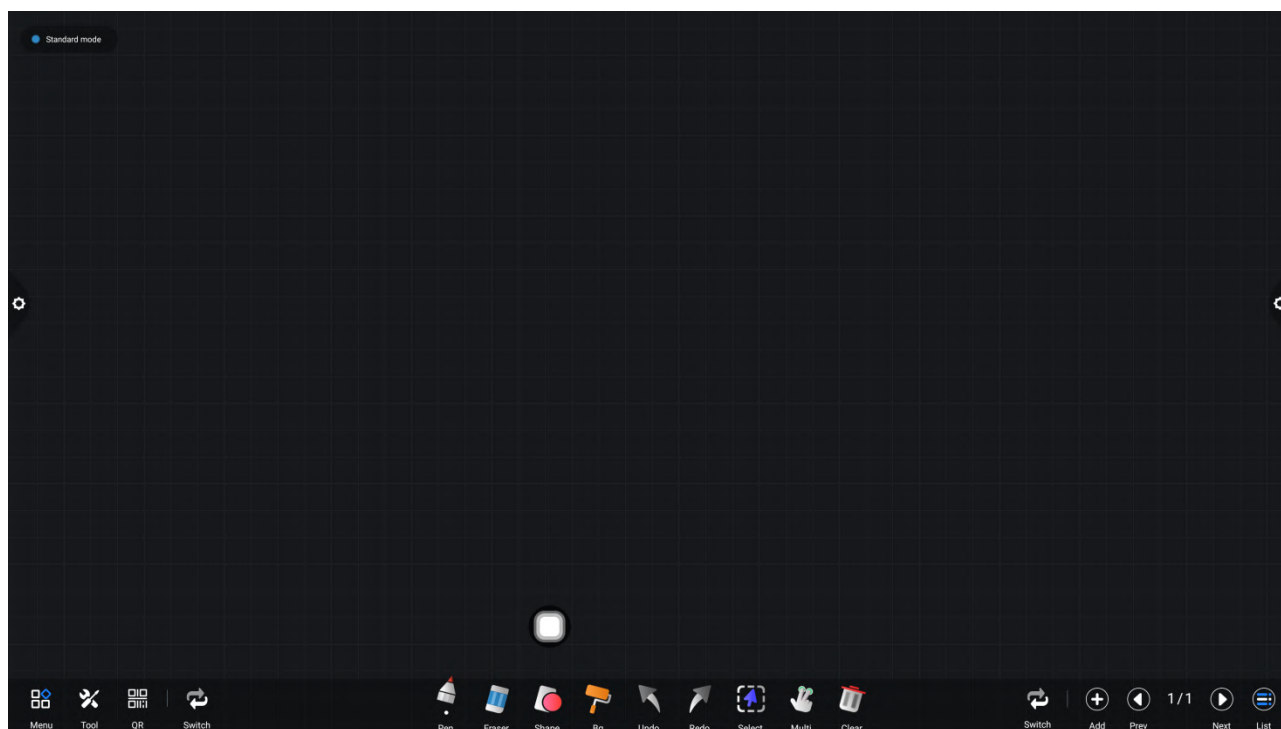

1. The whiteboard is selected by default and can be written directly.
2. Support single point mode and multi-point mode, multi-point support up to 20 points.
3. Single point mode, two fingers or more to perform zoom roaming function. It supports single stroke mode and double stroke mode, and the double pen mode is for stroke writing.
4. Support small tools, insert pictures and shapes, draw lines and arcs. You can also use some of the system's small tools, such as camera, calendar, calculator, etc.

#### Menu

5. Click  (menu icon) in the lower left corner of the interface, pop up display and display the lower content menu.

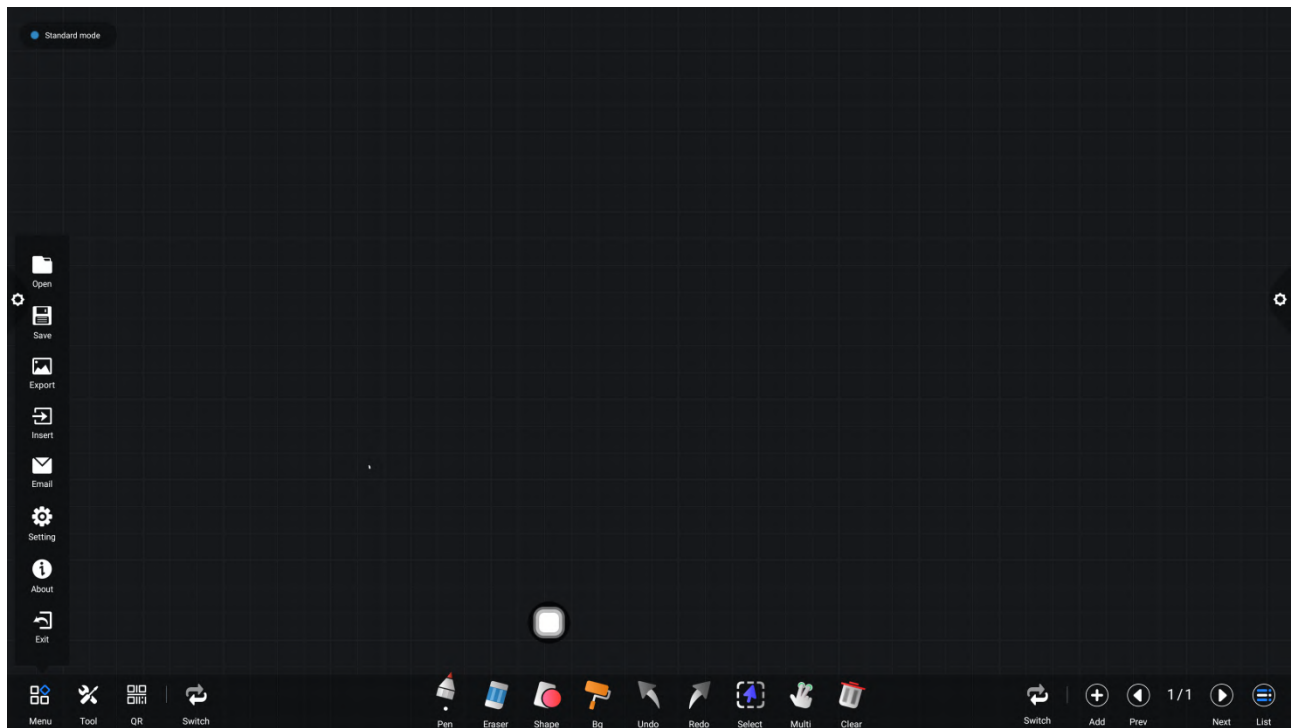

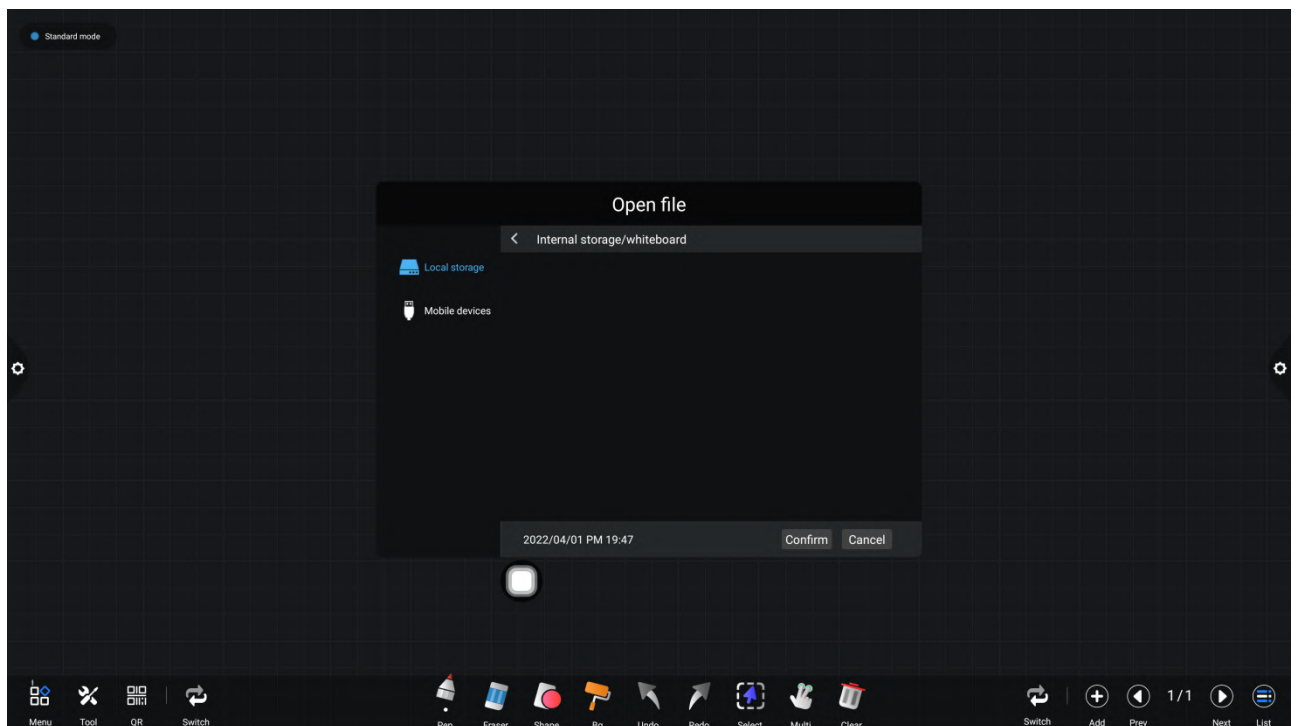

## 6. Content menu icon function operation instructions:

- (1) Open the file: Click  the icon to open and save the file under the whiteboard file directory (the default path directory is built-in storage / writeboard), click the file to open directly, and you can edit and save again.

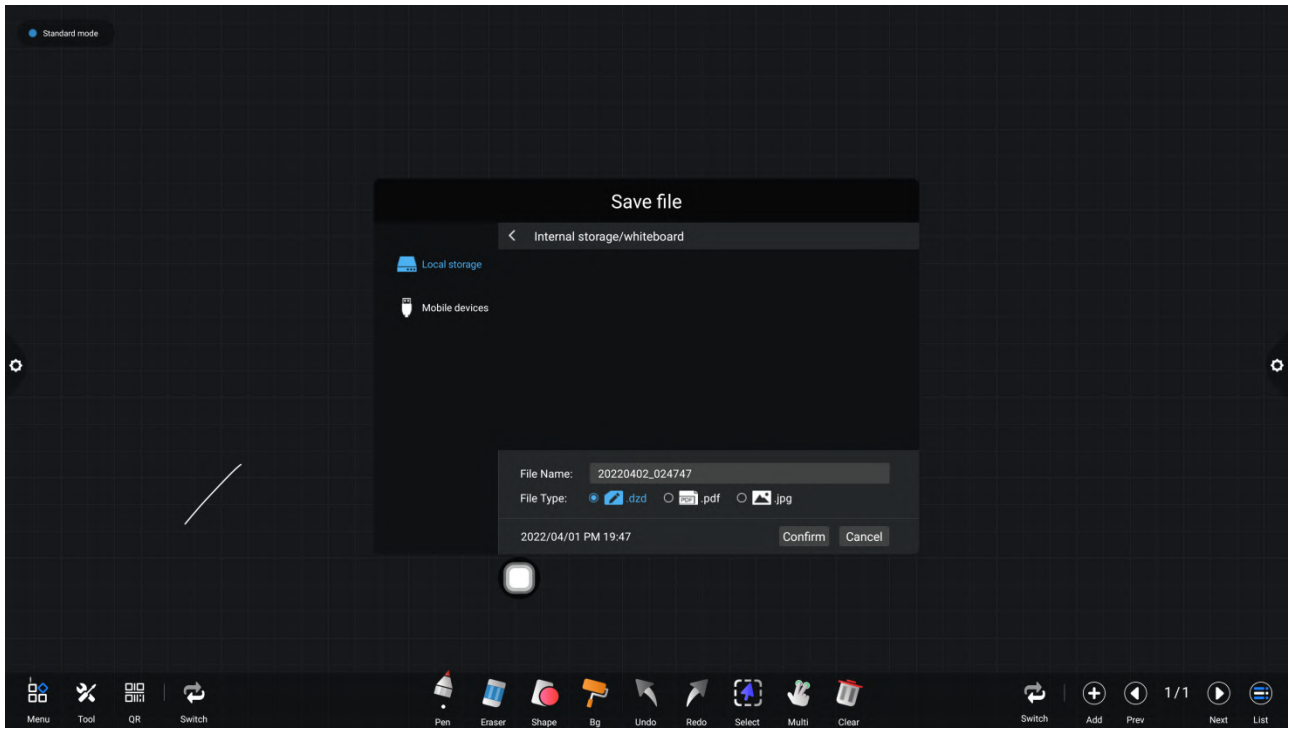

- (2) Save the file: Click  the icon to save the current writing content. The default time is named and saved. The user can customize the name to save. The user can select the built-in storage or U-disk to save the whiteboard file.



- (3) Export: Click  the icon to export the content written on the whiteboard in the image format \*. Jpg. The storage location of the exported image can be selected as built-in storage or USB flash disk.

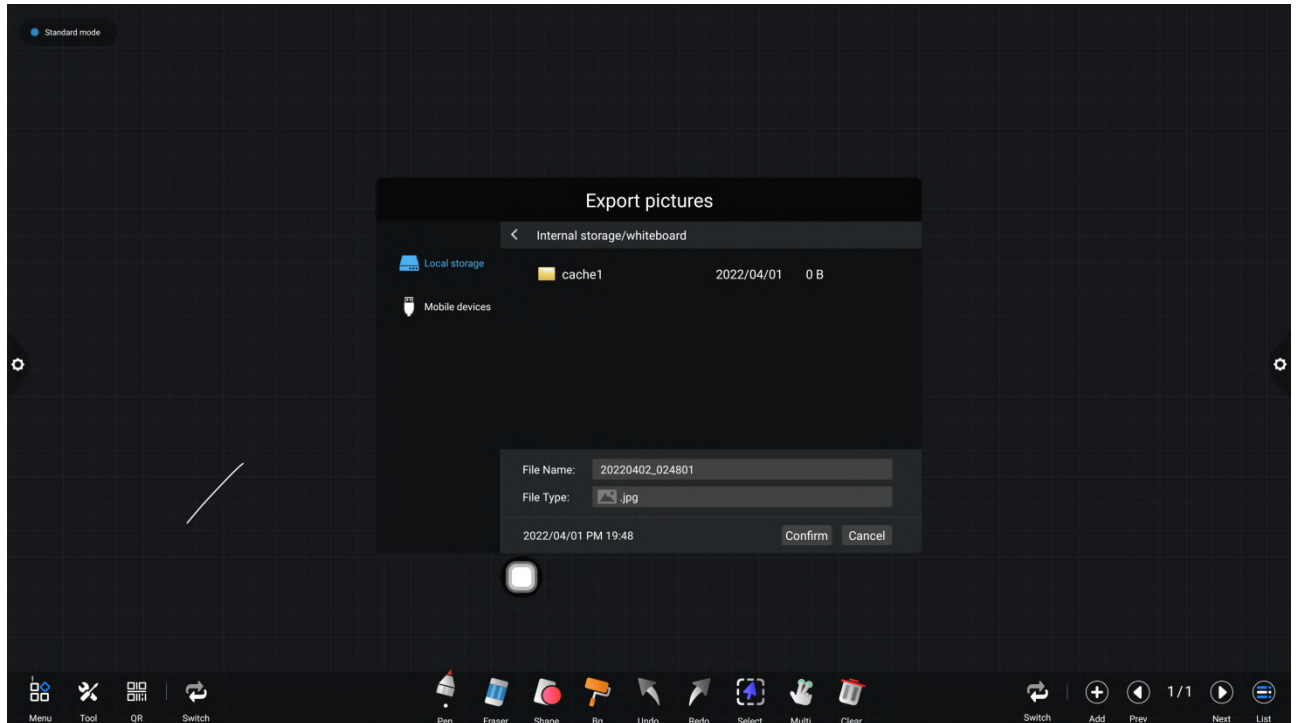

- (4) Insert: Click  the icon to open the local storage or U disk image file, the user can select the image to insert on the whiteboard, and the picture can be marked and written.

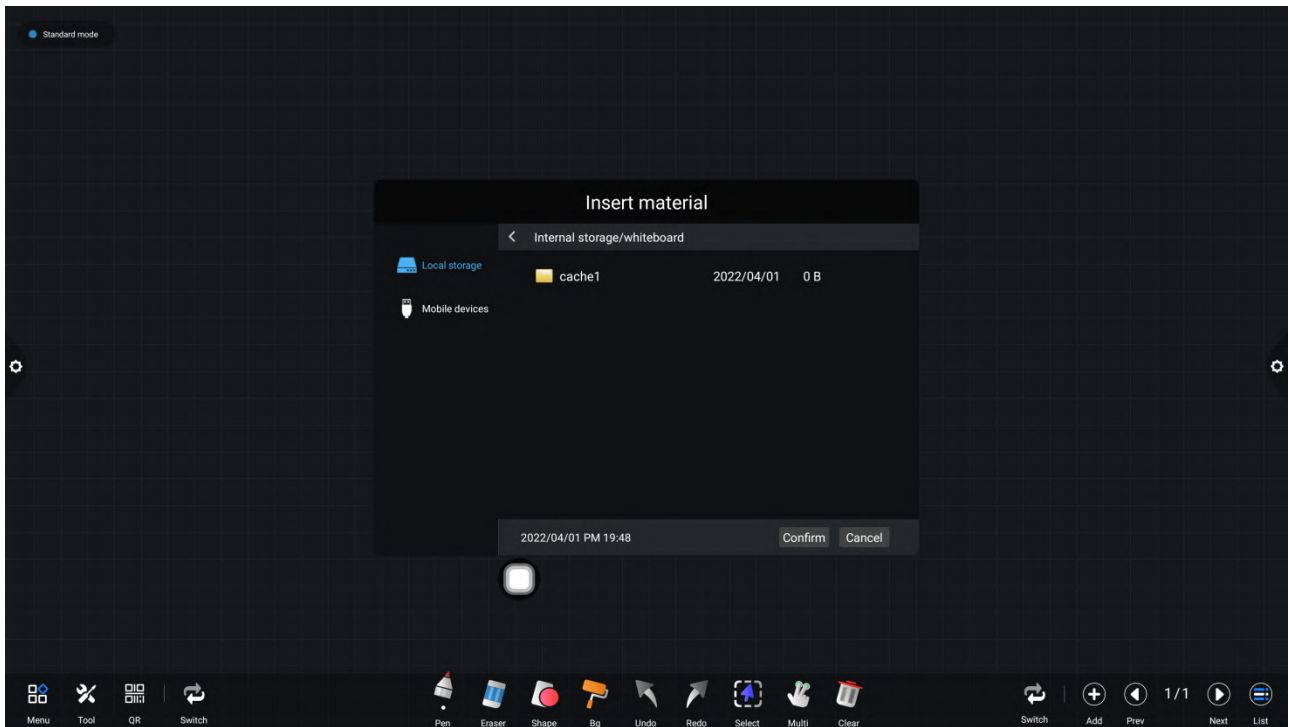

(5) Email: Click  the icon. When using the email sending function for the first time, you need to set the email sender's email information in the email login interface, as shown in the figure:

a. Use Tencent enterprise email, enter the account number and password, and click login.

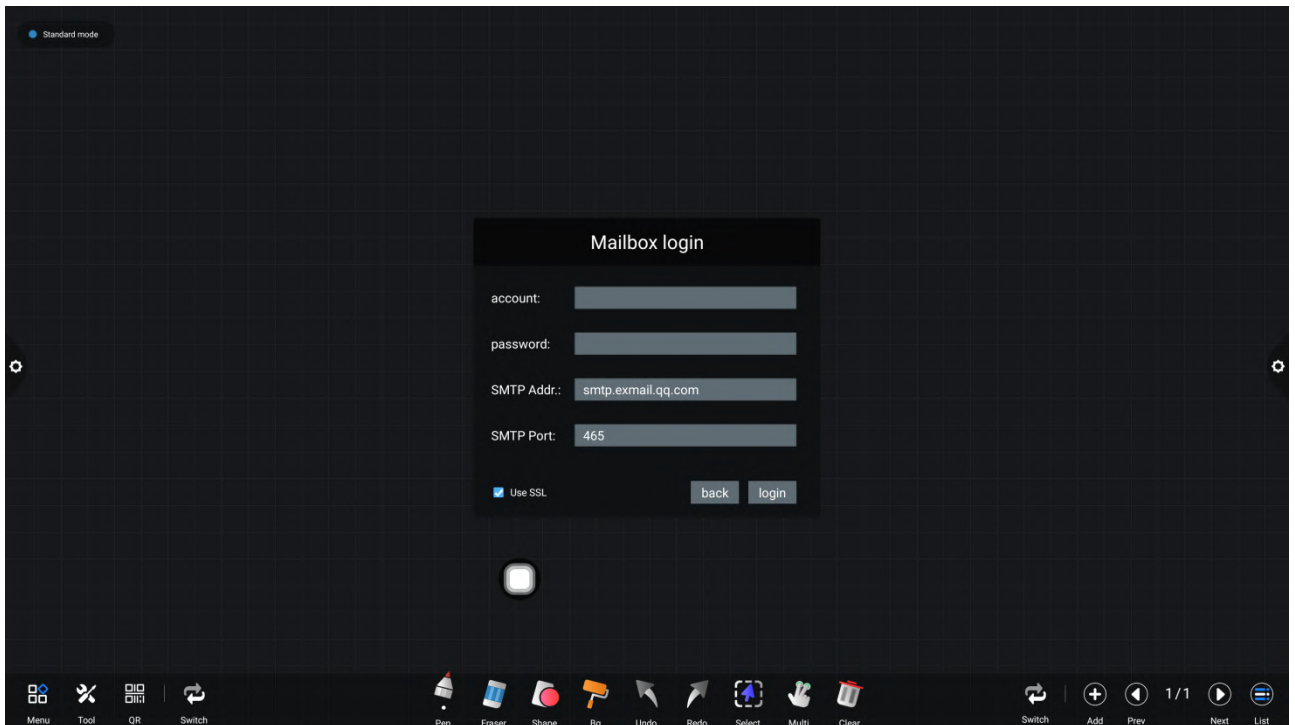

b. After successful login, the user enters the email address of the recipient, and then click send to record the contents on the whiteboard.

Pdf format file is sent to the recipient's mailbox, and click settings to modify and replace the current account number.

- (6) Click  the settings Icon to enter the network sharing settings and writing mode settings.
- a. Network sharing settings are divided into network sharing and local sharing functions.
  - b. The writing mode is divided into standard mode (single pen mode) and two-pen mode.
  - c. Other options are side write side wipe and finger wipe.

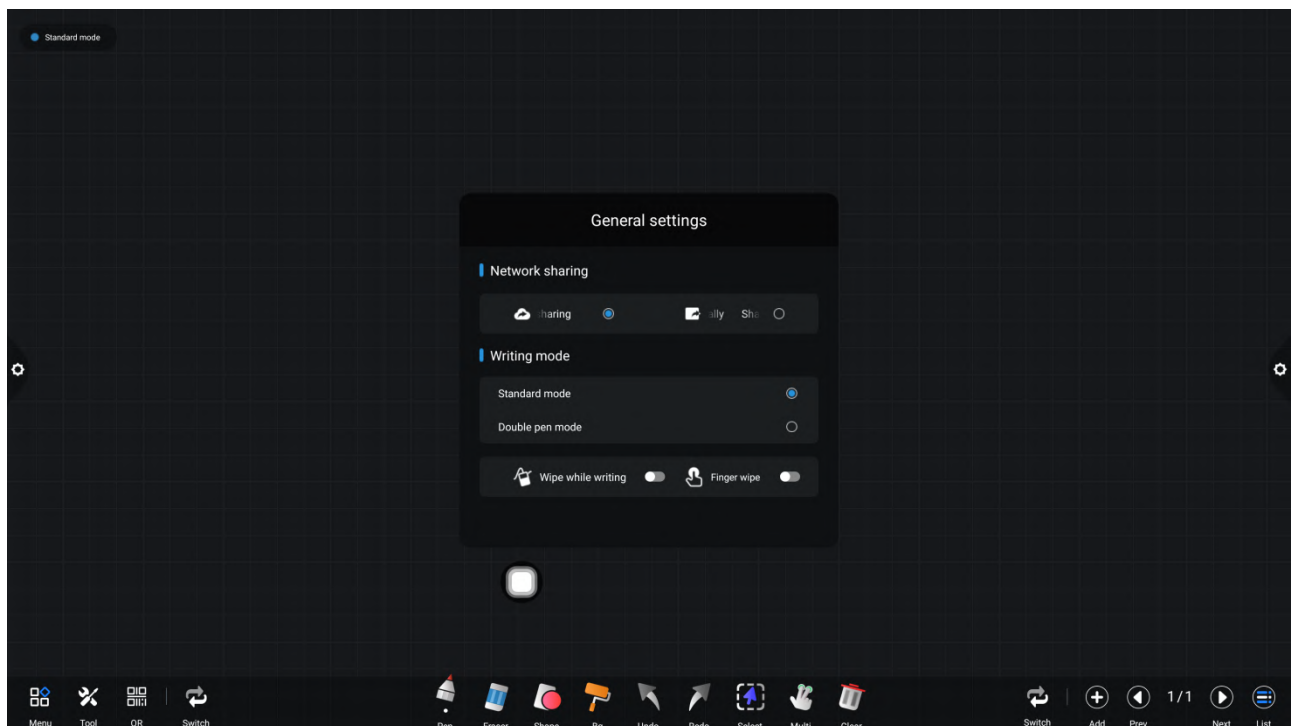

- (7) About: Click  the icon to view version information.

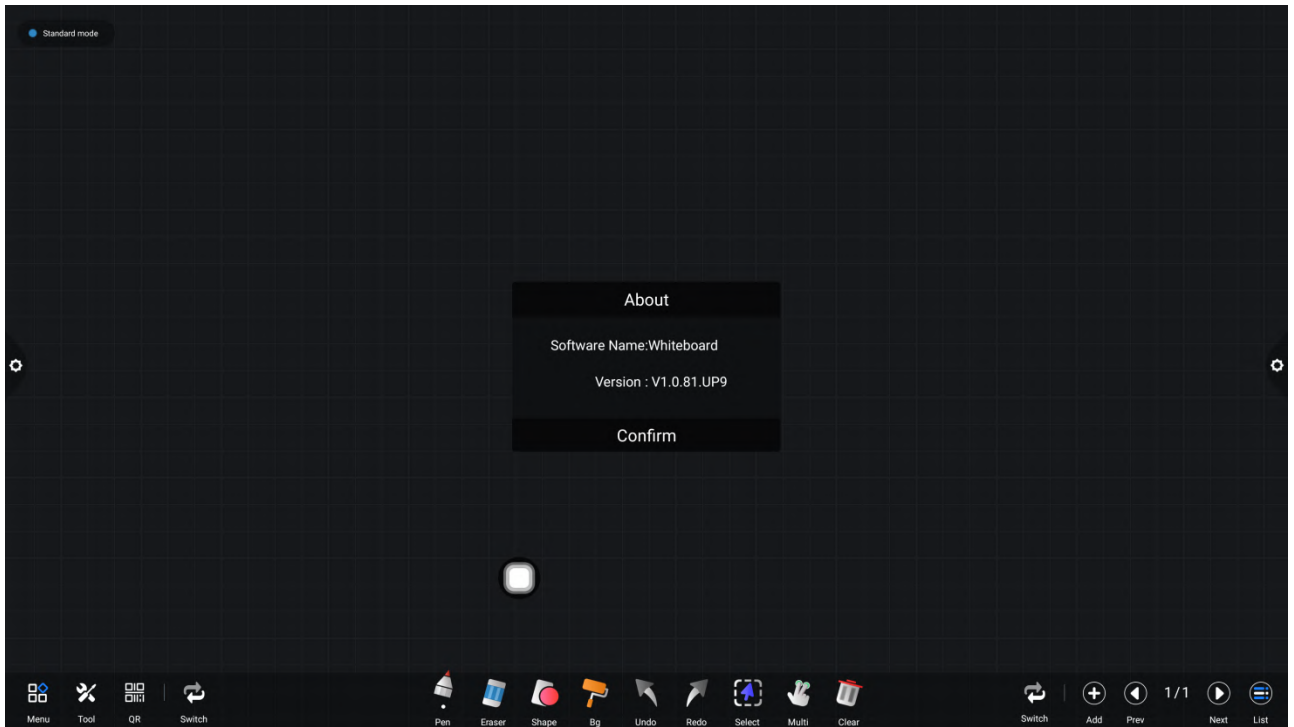

- (8) Exit: Click  the icon to exit the whiteboard when there is content on the whiteboard. A prompt will pop up: the whiteboard has not been saved. Do you want to save the whiteboard and exit the whiteboard. According to whether to operate the function or not; if the whiteboard has no content, click exit whiteboard to exit directly.

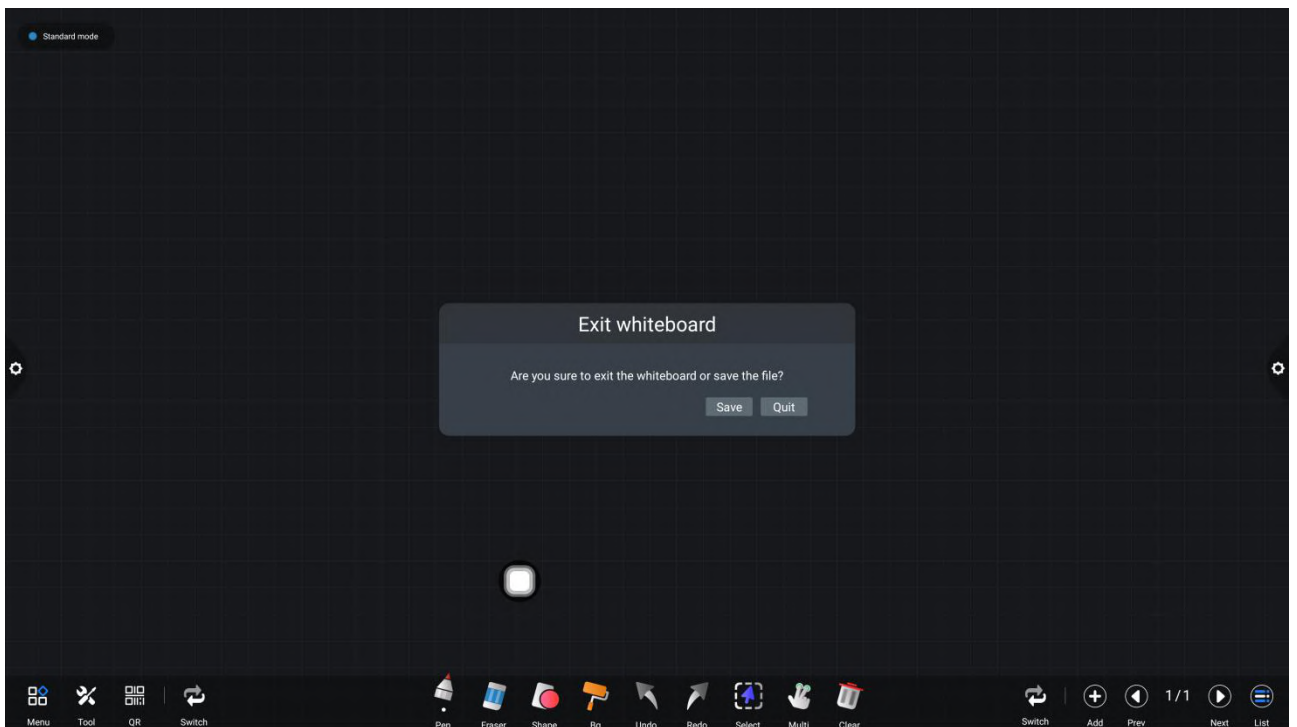

## Aid tools

The system has its own ruler, compass, and can be inserted into the system's calendar, camera, screen, calculator, timer and spotlight gadget.

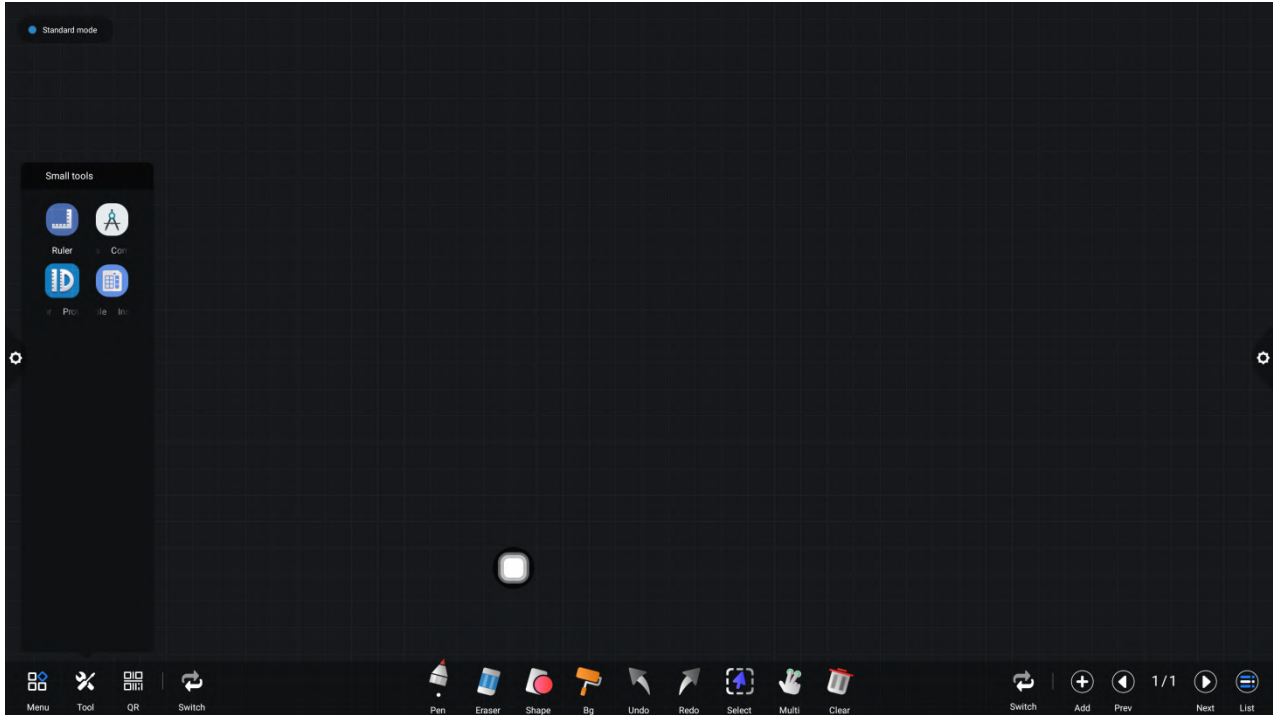

When the ruler is selected, the ruler tool appears on the screen, which can draw lines and mark the scale of lines.

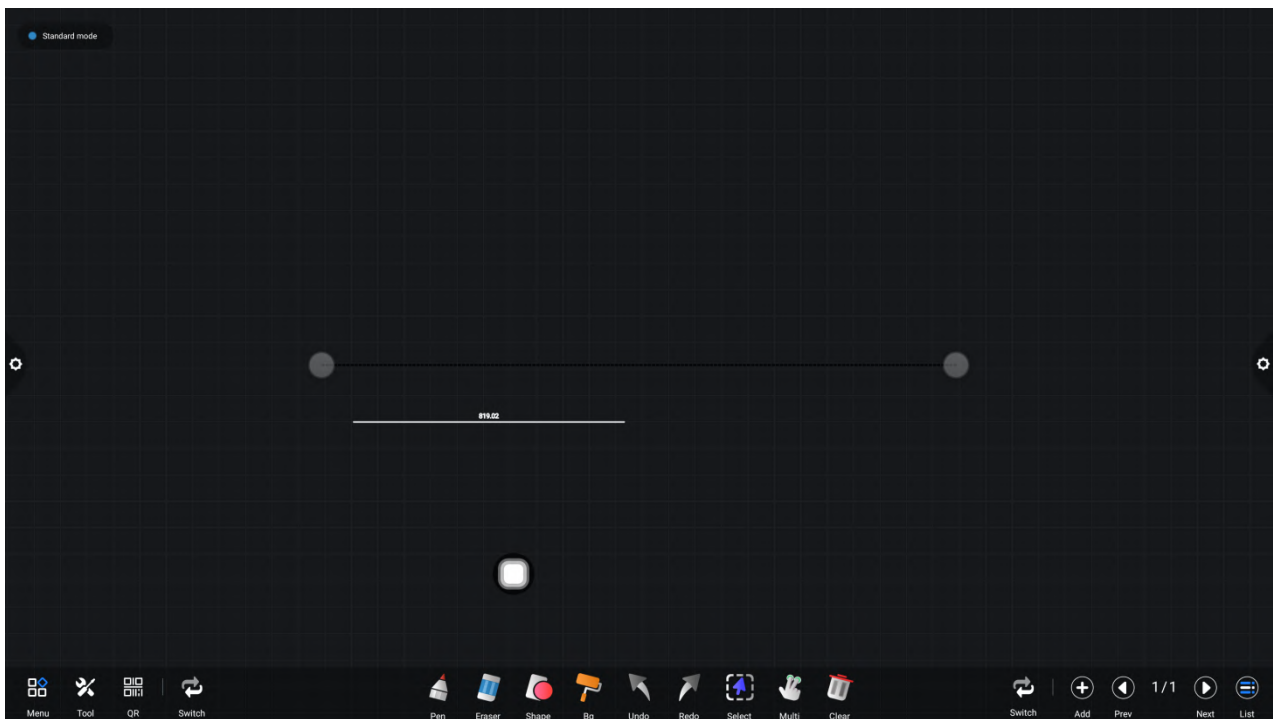

When you select a compass, you can draw circles or arcs on the screen.

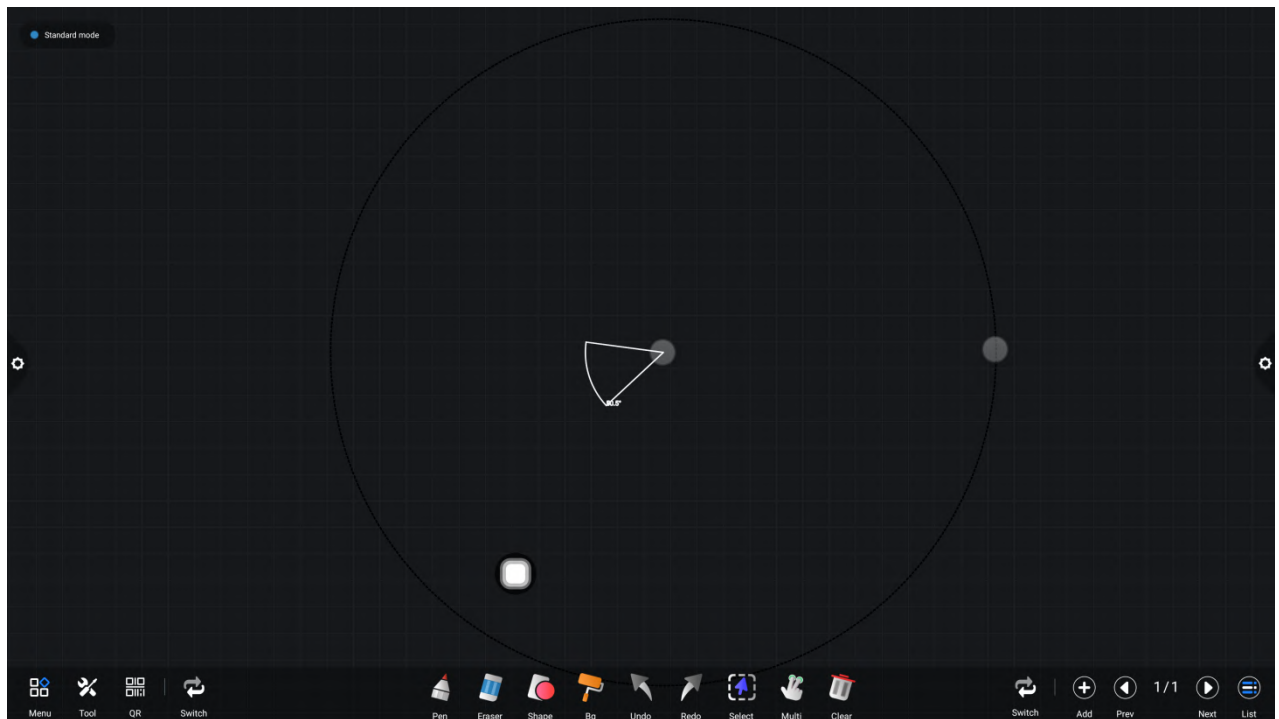

When selecting the calendar camera and other gadgets, the whiteboard application calls the application directly.

## Code scanning and sharing

Code scanning and sharing: Click  the icon and select the sharing type. When the network is connected, a two-dimensional code window can be generated, and the current conference record can be swept away through the wechat scan function; if prompted, return to the home page, click to enter the system settings to connect to the network, and scan the code again after the connection is successful.

QR code sharing is divided into current page sharing and all sharing.

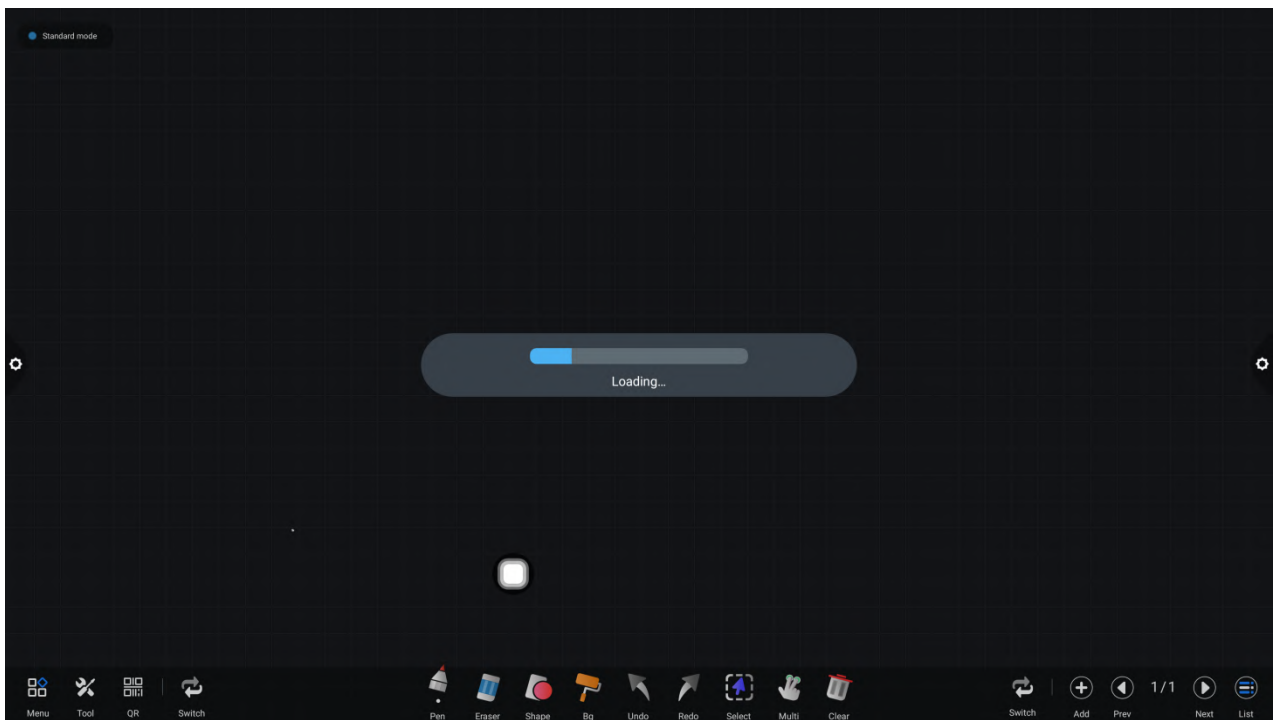
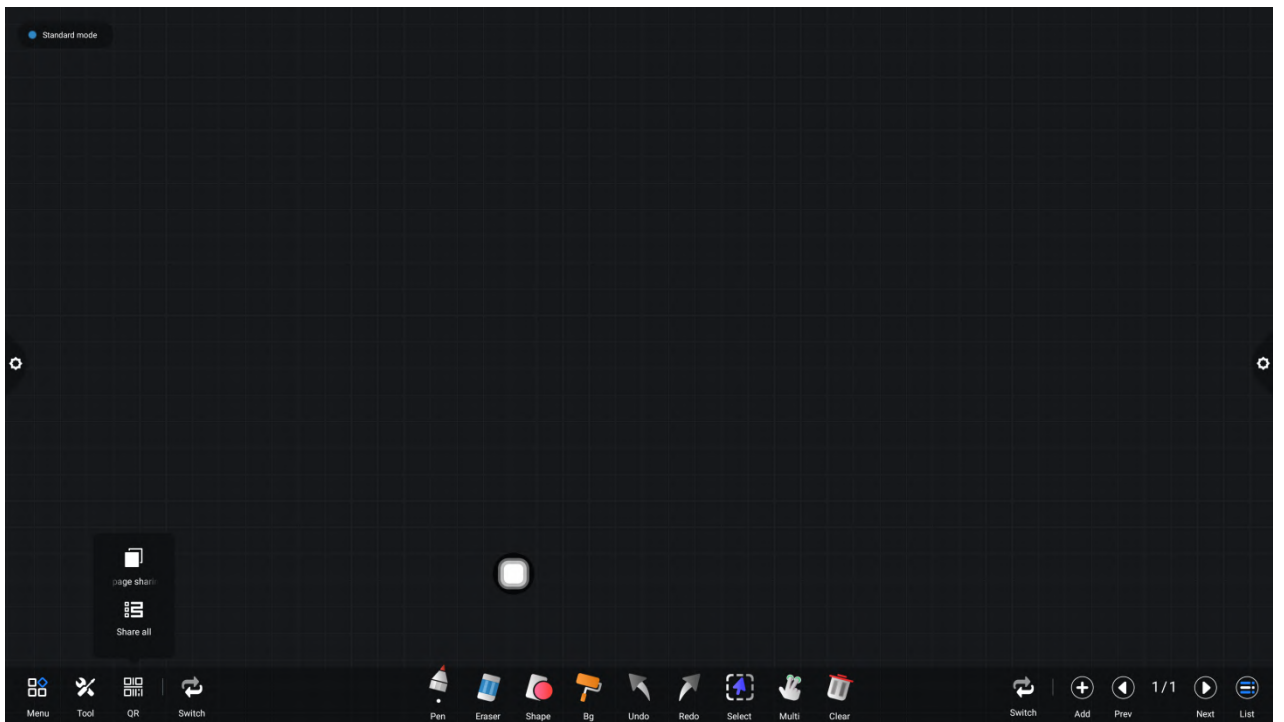

After the QR code is generated, the display is shown in the following figure. Click the lock icon to start the QR code lock mode, and the password is displayed next to it. After scanning the QR code, you must input the password before you can view the file.

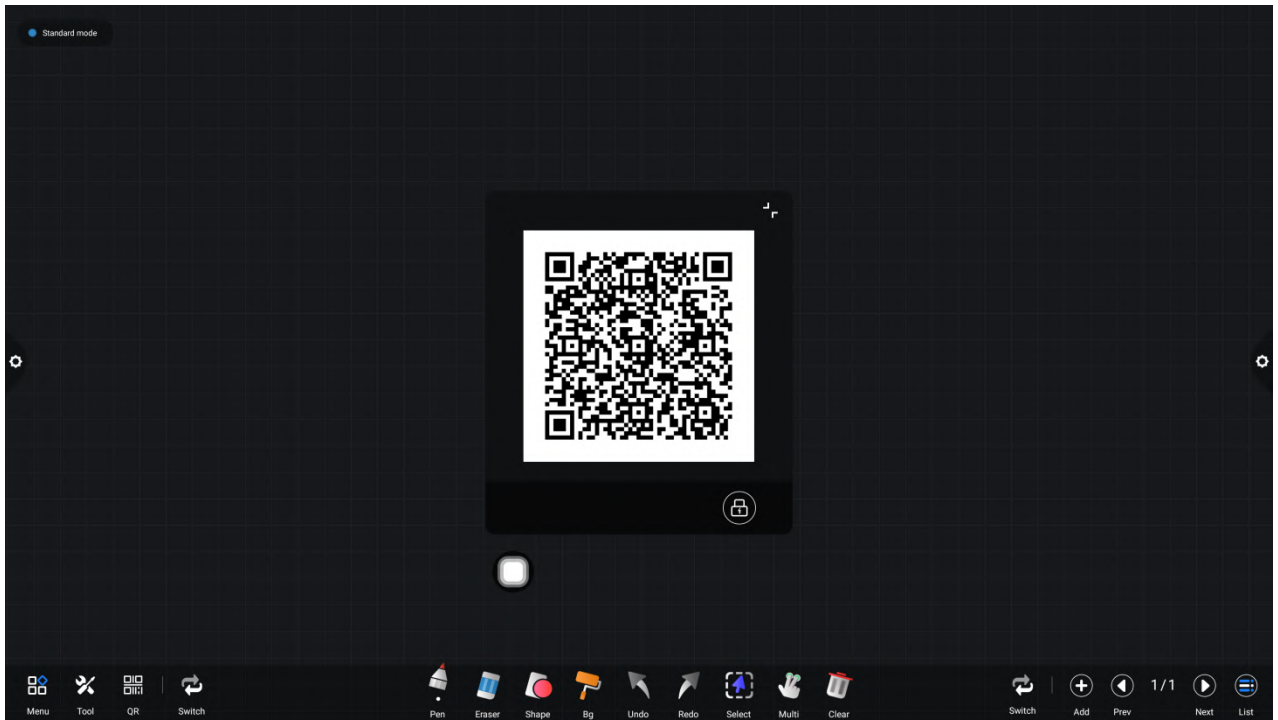

## Common Function

### 7. Brush tools

- (1) Click  the icon to call up the brush tools menu.
- (2) Change brush thickness and color.

Click the dot icon above to modify the stroke thickness, click the color box to select the brush color, and click the custom icon to expand the color palette to customize the brush color.

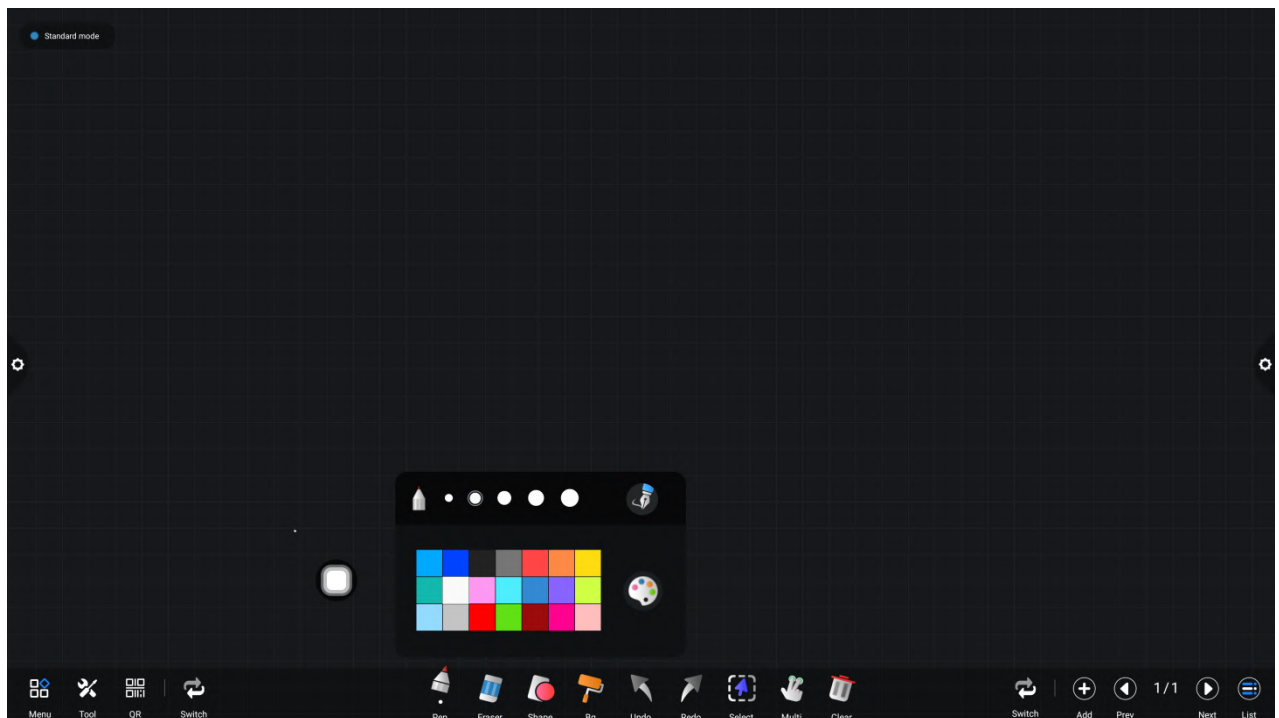

### 8. Eraser

(1) Click wipe: Click  the icon to erase the written content;

(2) Circle erase: Click  the icon to erase the handwriting in the area within the circle.

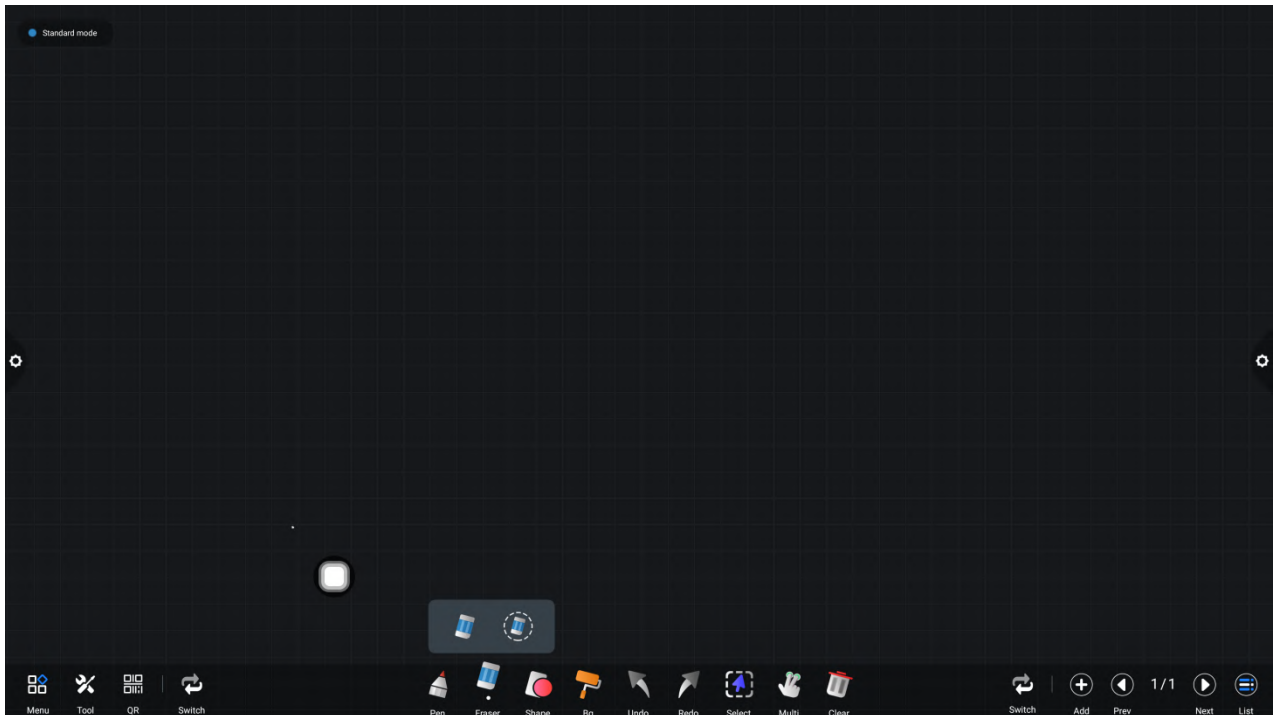

## 9. Shape

Click to  , pop up the graphic and image selection box. When the selected graph is drawn on the screen, it will be displayed as the corresponding figure.

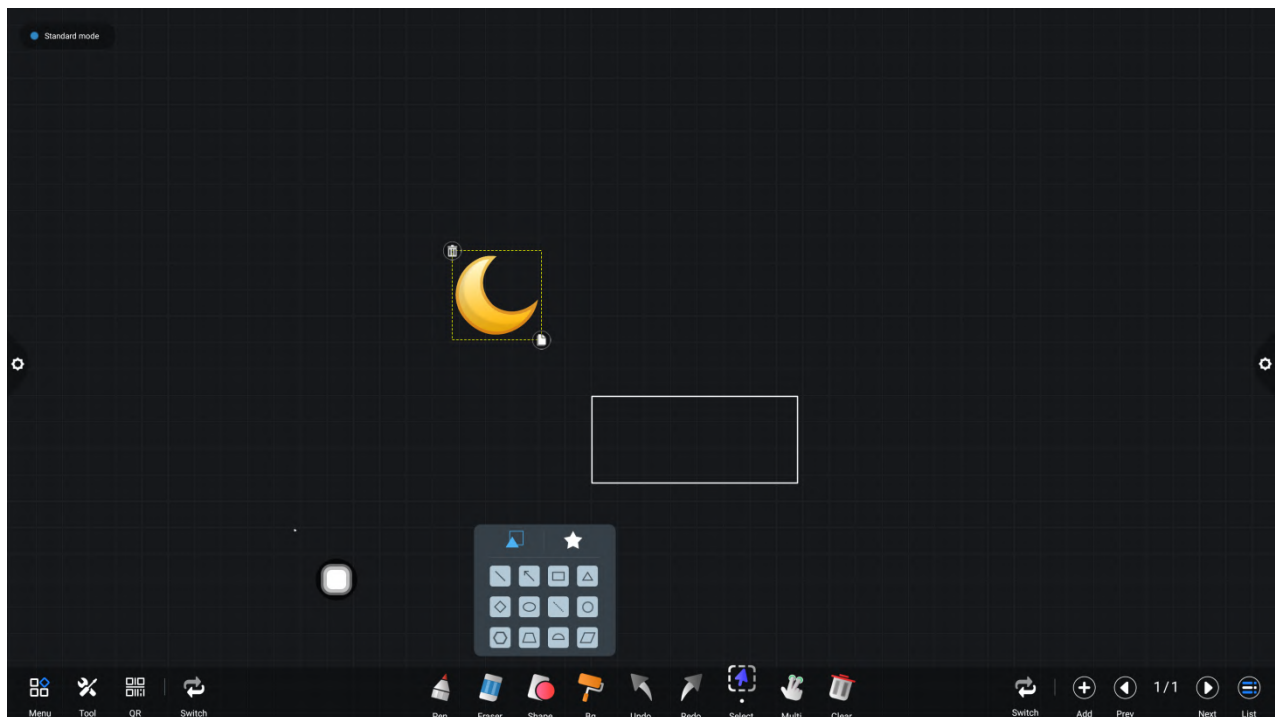

Click on the picture to insert the picture you just clicked on the screen.

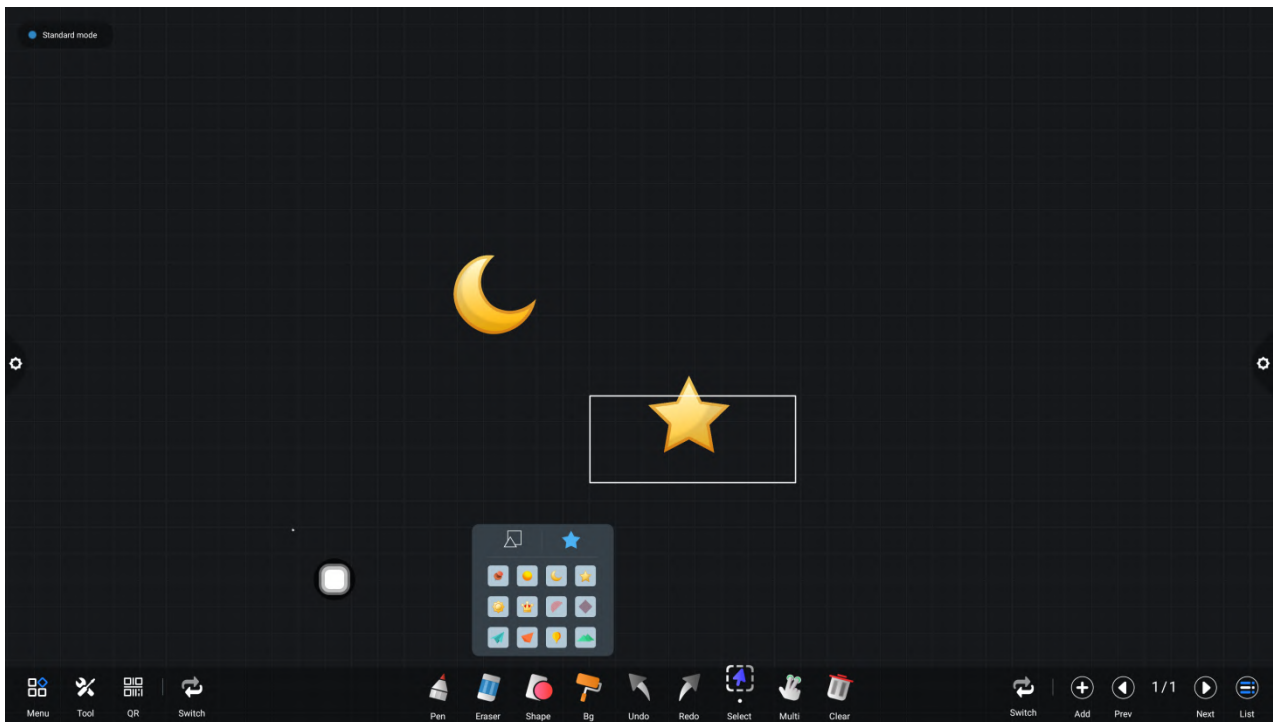

## 10. Background

(1) Click  to change the background color of whiteboard.

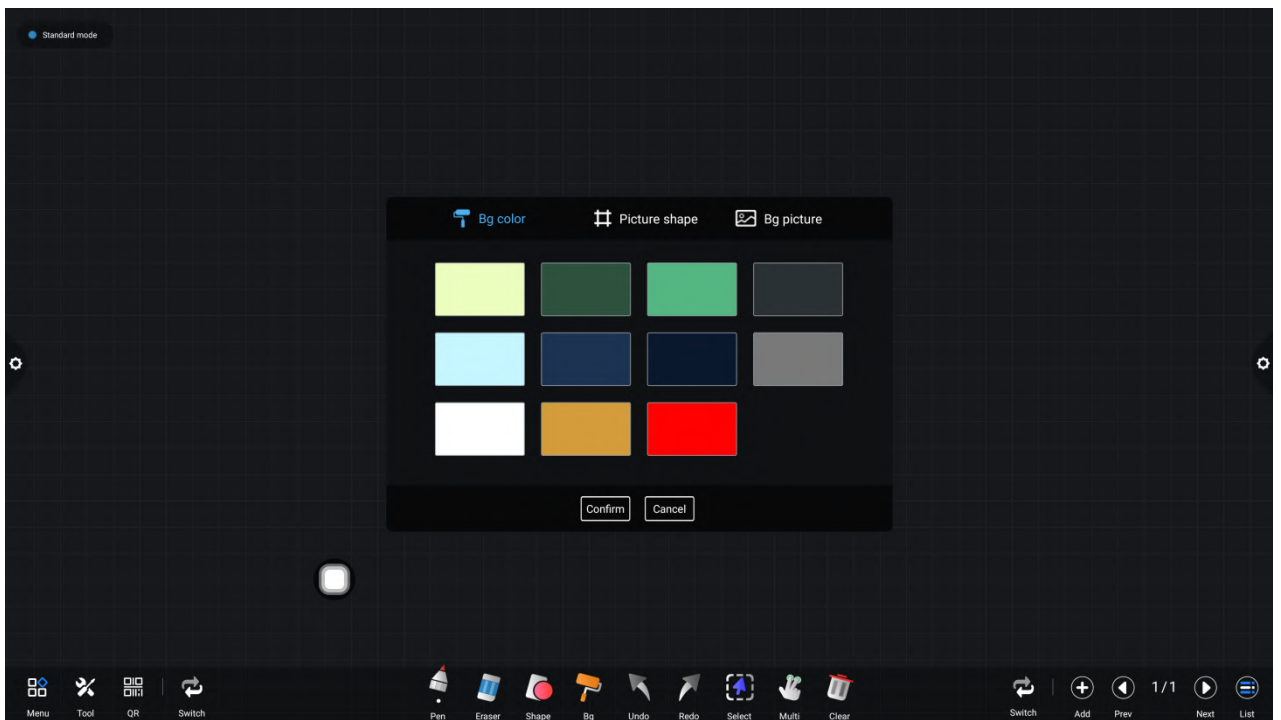

(2) Picture shape

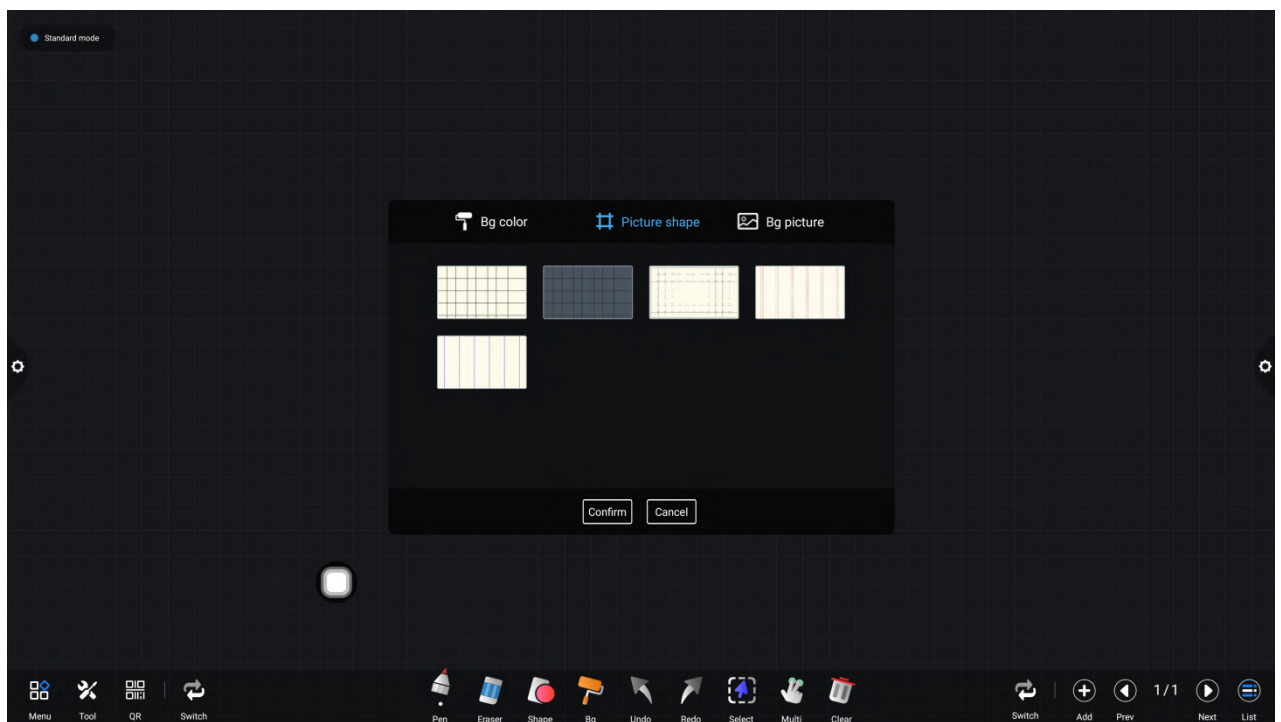

(3) Background image

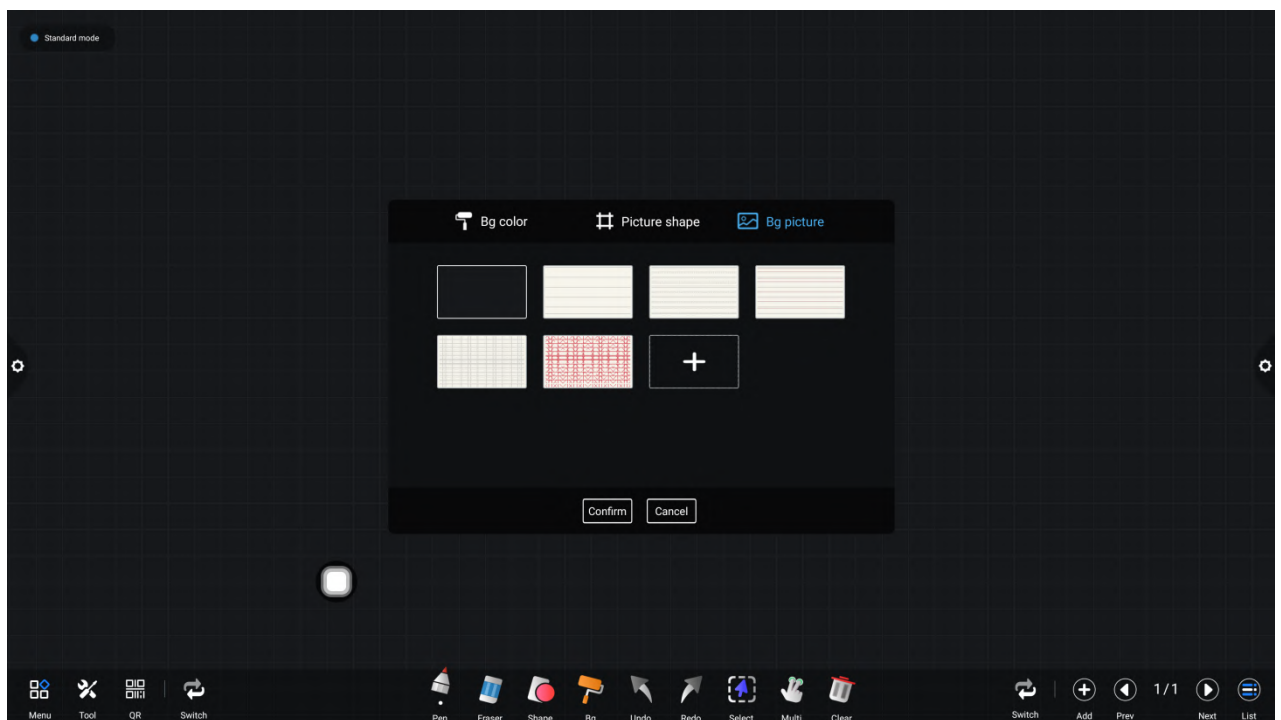

### 11. Revocation and restoration

(1) Undo:  icon to undo the previous operation. At most 50 steps can be undone at a time;

(2) Restore: Click  the icon to redo the operation that has been revoked. The maximum recovery steps are 50 steps at a time.

### 12. Select function



---

Click  to select the selection function, and the interface switches from writing mode to selection mode. The handwriting and shape in the interface can be drawn, and then the functions of moving, deleting, copying and pasting can be realized for the inserted pictures.

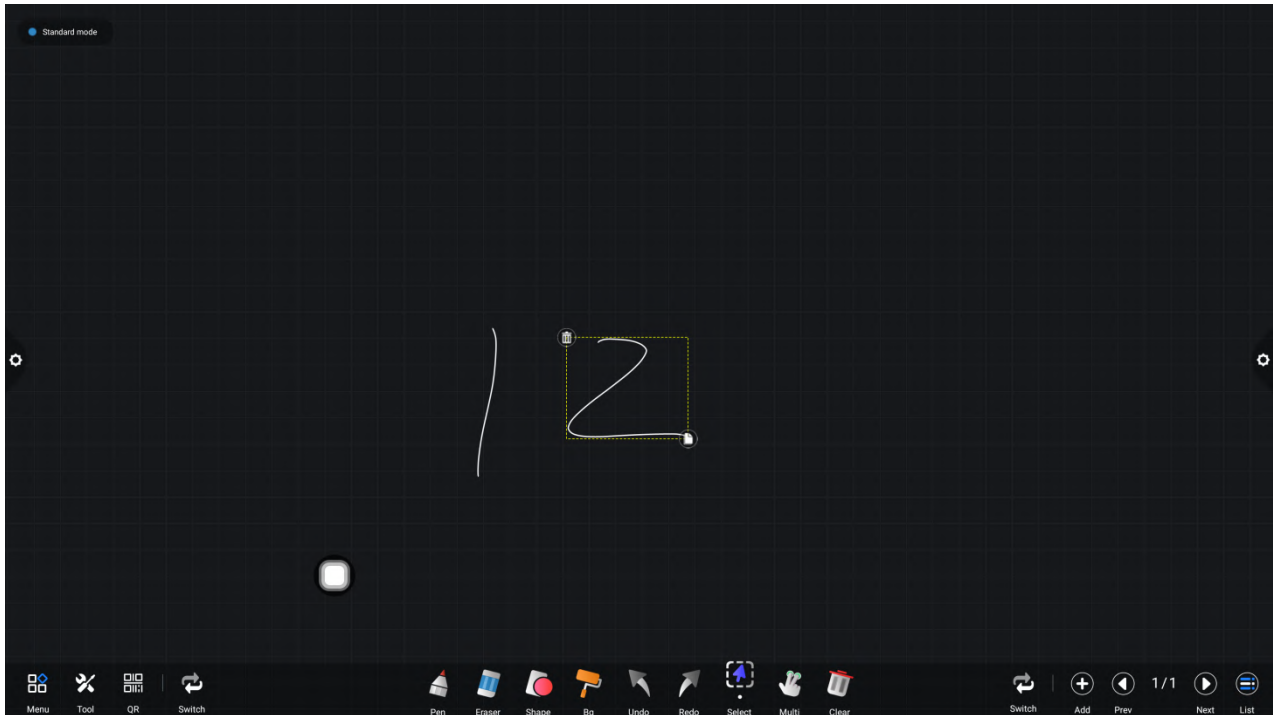
Move, delete, copy and paste, rotate and zoom.



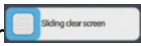

### 13. Slide screen cleaning function

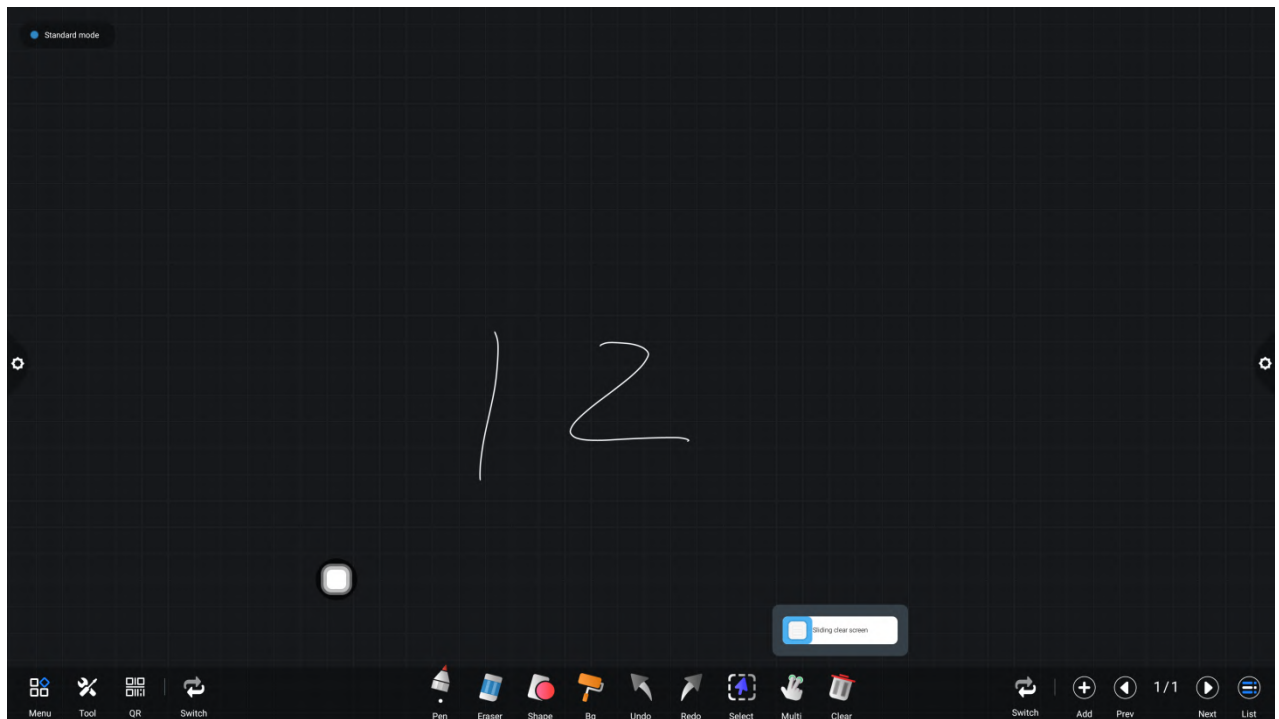
Click  the icon to call up the slider , and manually slide the icon  to the right to clear the writing content on the current screen.



### Left and right switching function

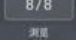

Click  the icon to switch the left and right positions of more function icons, code scanning and switching function icons  with the function icons on the upper and lower pages, page preview function icons  and page adding function icons.

### 14. Page preview

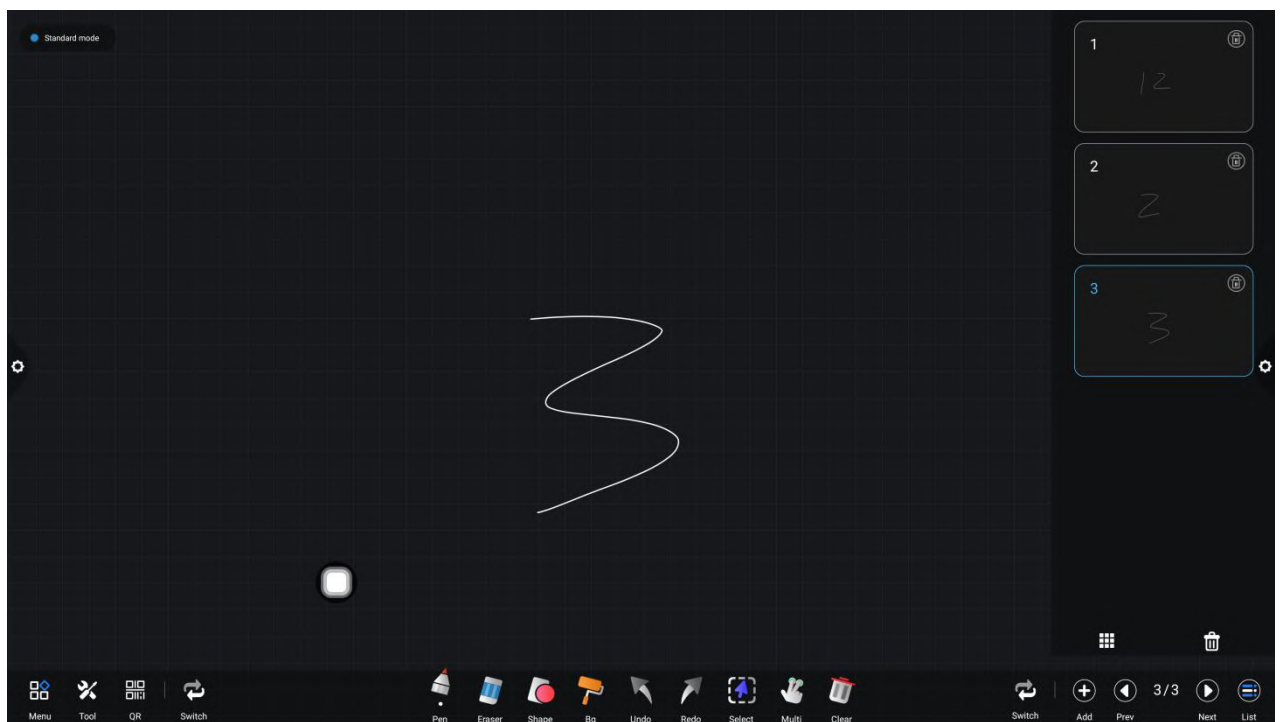
Open the page preview pop-up window: Click  to show that the current page is selected.



(2) Add page: Click  the icon to add a page.

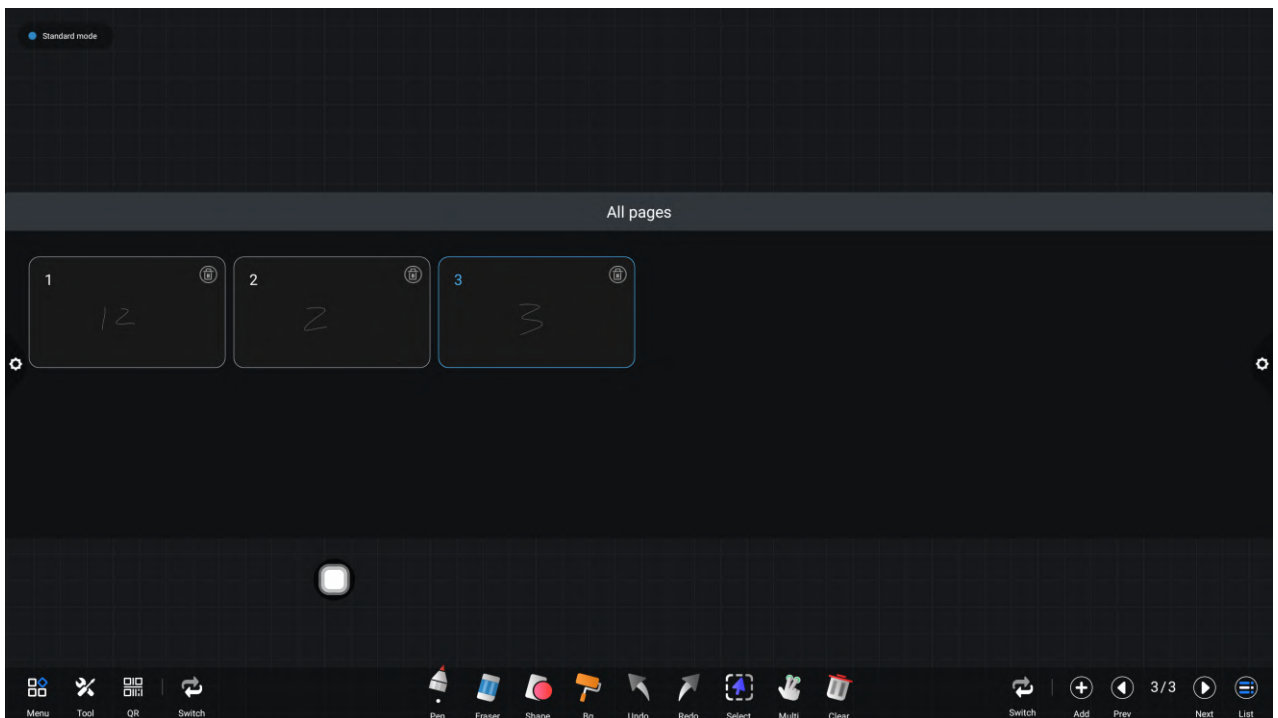

(3) Delete page: In the open page preview window, click  the delete button in the upper right corner of the page thumbnail to delete the page or click  at the bottom of the page preview window to delete all pages. to Click  enter all page display mode.

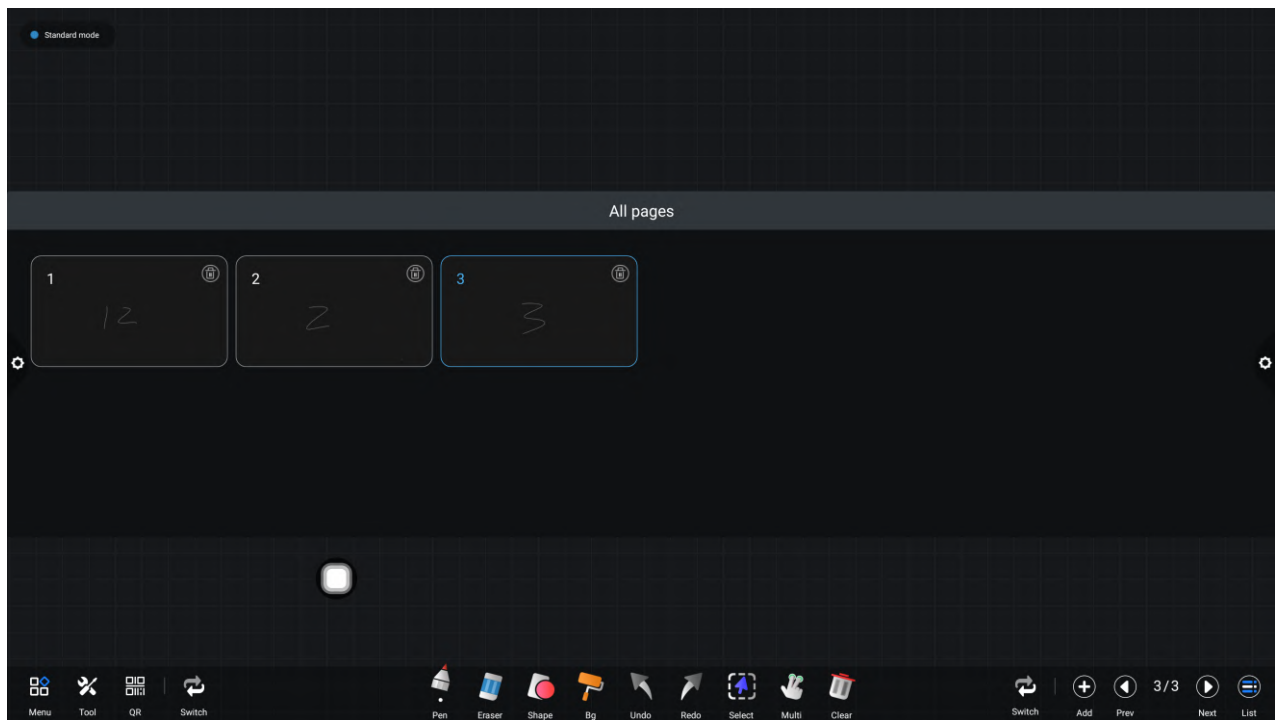

Delete page or delete at the bottom of page preview window, press to delete all pages.

Click  icon to enter all page display mode.



(4) Page turning function: Click the left  and right  page turning button and icon to realize page turning effect. In the page preview window, if the preview page exceeds the Limited Preview range, slide up and down quickly;

Click  to select to achieve page up and down function.